

## ELECTRICAL SPECIFICATIONS

COMMON MODE CHOKE (each winding)			
L - ±10% μH	IRMS - MAX AMPS	R - ±15% OHMS	SELF RES. TYP - MHz
231	1.2	.13	2.6

## SCHEMATIC

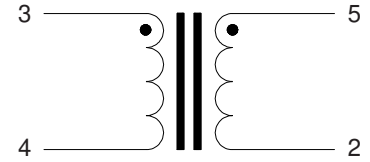

## MECHANICAL SPECIFICATIONS

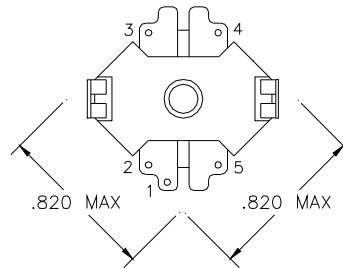
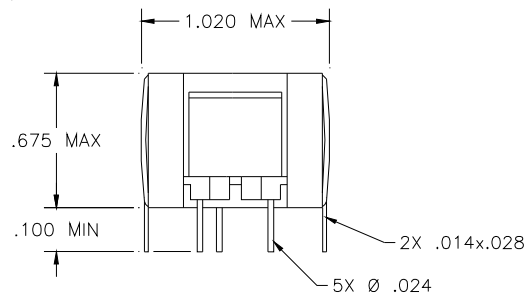

BOTTOM VIEW

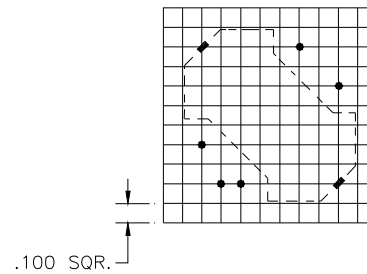

PCB FOOTPRINT  
(TOP VIEW)

## NOTES

1. Inductance measured at 1 V, 10 kHz.
2. MAX Amps rating (AC or DC) is for a 40°C rise.
3. Maximum operating temperature is 130°C.
4. All electrical data at 20°±5°C.

	INIT.	DATE	CAGE 09349	<b>MAGNETIC CIRCUIT ELEMENTS INC.</b> www.MCEmagnetics.com, ph. 831-757-8752, fax 831-757-5478				
PROD.	CP	8-24-15						
ENG.	JC	8-24-15		COMMON MODE CHOKE - RF				
Q.A.			TEST CONDITION 20° ± 5° C	DECIMALS (IN.) .XX = ± .03 .XXX = ± .010	VOLTS ±5%	FREQUENCY ±5%	SIZE A	DWG. NO. <b>O-1977L17</b>
REV.								